

# Wenlock & Taylor



## Donnington Court Donnington Road

Willesden, London, NW10 3TJ

£2,000 Per Calendar Month

There cannot be many properties in NW10 with better views across London than from the magnificent south facing roof terrace and balcony at this flat. Located on the 8th Floor within a secure modern purpose built block, this flat has 827 sq.ft (77 sq.m) approx of accommodation comprising 2 double bedrooms, a light filled 20ft reception with open plan kitchen and bathroom/wc. The property has electric heating, double glazed windows, pre-assigned underground car parking space and the block has 24 hour portage. Situated close to King Edwards Park/Willesden Sports Centre, Roundwood Park and walking distance from the shops and (Jubilee Line) station at Willesden Green.

Available: Now

Council Tax: Brent Band E.

Offered: Unfurnished.

- 8th FLOOR FLAT IN SECURE MODERN BLOCK
- 2 DOUBLE BEDROOMS
- 500 sq.ft SOUTH FACING ROOF TERRACE & BALCONY
- UNFURNISHED
- 24 HOUR PORTERAGE
- UNDERGROUND CAR PARKING
- CLOSE TO WILLESDEN SPORTS CENTRE & ROUNDWOOD PARK
- AVAILABLE NOW

### Viewing

Please contact our Wenlock & Taylor Office on 020 8969 0122 if you wish to arrange a viewing appointment for this property or require further information.





Floor Plan

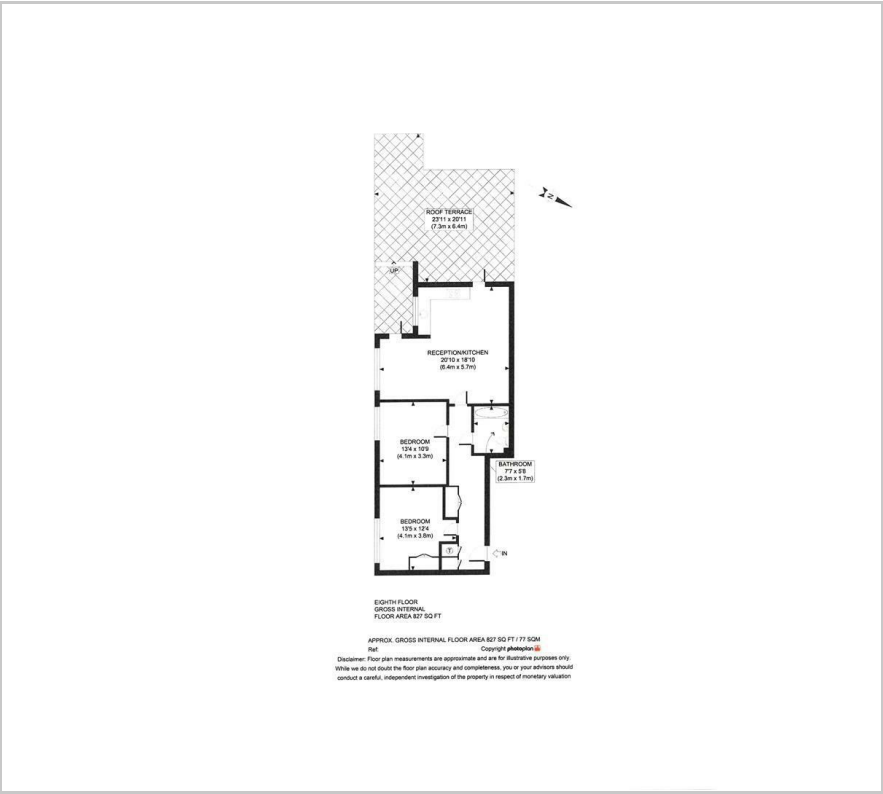

Area Map



Energy Efficiency Graph

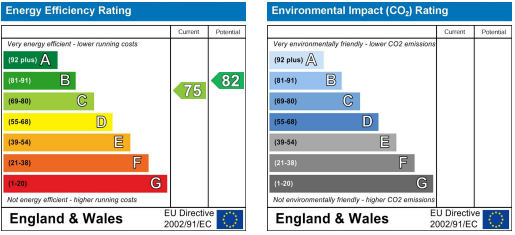

These particulars, whilst believed to be accurate are set out as a general outline only for guidance and do not constitute any part of an offer or contract. Intending purchasers should not rely on them as statements of representation of fact, but must satisfy themselves by inspection or otherwise as to their accuracy. No person in this firms employment has the authority to make or give any representation or warranty in respect of the property.